

HGC1214 HGC1416

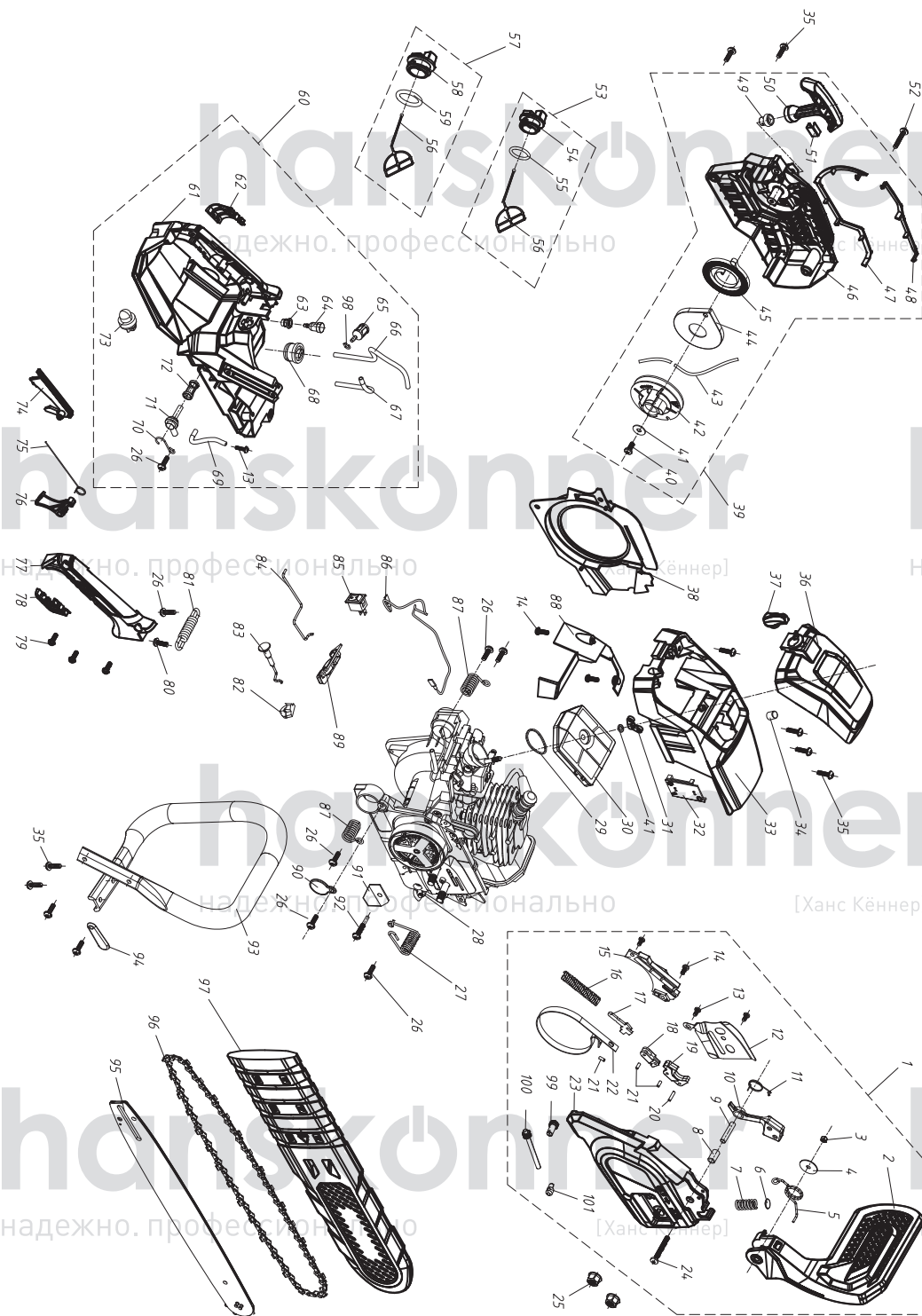

| No. | Description | No. | Description |
|-----|--------------------------------|-----|------------------------------|
| 1 | Brake Assy | 52 | Screw ST5X20 |
| 2 | Brake Conductor | 53 | Fuel oil cap assembly |
| 3 | Nut M5 | 54 | Fuel oil Cap |
| 4 | Washer 5X23X1.2 | 55 | Rubber Washer 22X4 |
| 5 | Spring | 56 | CE Line |
| 6 | AV Spring Plate | 57 | Machine oil cap assembly |
| 7 | AV Spring 2X10X26 | 58 | Machine oil cap |
| 8 | Pin | 59 | Rubber Washer 20X3.5 |
| 9 | Pin | 60 | Oilcan assembly |
| 10 | Brake Balance weight | 61 | Oilcan |
| 11 | Spring | 62 | Oilcan decorative cover |
| 12 | Tensioner Cover | 63 | Valve Mount |
| 13 | Screw ST4X8 | 64 | Filter Valve |
| 14 | Screw ST4X10 | 65 | Filter |
| 15 | Brake Spring cover | 66 | Fuel Pipe 5x205 |
| 16 | Brake Spring 2X9X71 | 67 | scavenge pipe |
| 17 | Brake Knee | 68 | Fuel Pipe Mount |
| 18 | Knee Link Back | 69 | Rubber Pipe 5X65 |
| 19 | Brake Knee link Front | 70 | Oil Filter Mount bead flange |
| 20 | Pin Ø3X14 | 71 | Oil Filter Mount |
| 21 | Pin Ø3X8.8 | 72 | Oil Filter |
| 22 | Brake Steel | 73 | Gas Pump |
| 23 | Clutch Cover | 74 | Trigger Catcher |
| 24 | Screw M5X4.0 | 75 | Trigger Spring |
| 25 | Nut M8X1.25 | 76 | Trigger |
| 26 | Screw ST5X14 | 77 | Rear Handle cover |
| 27 | Handle AV Spring | 78 | Rear Handle decorative cover |
| 28 | Chain saw power assembly | 79 | Screw ST4X12 |
| 29 | Air Filter Gasket | 80 | Screw M5X14 |
| 30 | Air filter | 81 | Spring |
| 31 | Nut M5 | 82 | Choke Rod Mount |
| 32 | Stop Wind Plate | 83 | Choke Rod |
| 33 | Top Cover | 84 | Carburetor Rod |
| 34 | Air Filter Anti Vib | 85 | Switch |
| 35 | Screw ST5X16 | 86 | Red wire |
| 36 | Air Filter Cover | 87 | torsional spring |
| 37 | Air filter cover Nut | 88 | Top cover top cover |
| 38 | Air Fairing | 89 | Carburetor scavenge pipe |
| 39 | Motor starter assembly | 90 | torsional spring cover |
| 40 | Screw ST5X12 | 91 | Chain Cacher |
| 41 | Washer 5x16x1 | 92 | Chain Cacher Screw |
| 42 | Pulley | 93 | Front Handle |
| 43 | Start Line 3X900 | 94 | Front Handle Spring Plate |
| 44 | Coil spring seat | 95 | Guide board |
| 45 | Coil spring | 96 | Chain |
| 46 | Starter Cover | 97 | Slipcover |
| 47 | Starter decorative left cover | | |
| 48 | Starter decorative right cover | | |
| 49 | Sleeve | | |
| 50 | Starter handle | | |
| 51 | Starter handle cover | | |

ENGINE FOR HGC1214 HGC1416

| No. | Description | No. | Description |
|-----|-------------------------------|-----|--------------------------|
| 1 | Nut/M5 | 33 | Screw M5X50 |
| 2 | Muffler plate | 34 | AV cover/120 |
| 3 | Muffler | 35 | Crank Case Mount |
| 4 | Muffler Washer | 36 | Screw M5X14 |
| 5 | Muffler srew 5X60 | 37 | Oil Pipe Connector |
| 6 | Piston Criclip | 38 | Oil Pipe/7X80 |
| 7 | Piston Needle Washer | 39 | Black wire |
| 8 | Piston Pin | 40 | Hole Circlip |
| 9 | Needle Bearing K10X14X11 | 41 | Right Crank Case |
| 10 | Crank Shalft | 42 | Screw M5X30 |
| 11 | Piston | 43 | Oil Seal 32X12X5.5 |
| 12 | Piston Ring | 44 | Washer 10X18X1 |
| 13 | Cylinder Gasket | 45 | Oil Pump |
| 14 | Cylinder | 46 | Oil Pump Filter Sponge |
| 15 | Screw M5X20 | 47 | Screw M4X14 |
| 16 | Spark Plug | 48 | Oil Pump Cover |
| 17 | Ignition module | 49 | Screw M4X12 |
| 18 | Screw /M4X14 | 50 | Warm |
| 19 | Nut/M8X1 | 51 | Clutch hup |
| 20 | Fly wheel | 52 | Needle Bearing K10X13X13 |
| 21 | Oil seal 12X22X7 | 53 | Steel Washer |
| 22 | Left Crank case | 54 | Clutch assembly |
| 23 | Crank Case Gasket | 55 | Clutch block |
| 24 | Pin ϕ 3X8 | 56 | Clutch spring |
| 25 | 6201 bearing C grade 12X32X10 | 57 | Clutch bracket |
| 26 | Key 3X3.75X10 | 58 | Screw M4X10 |
| 27 | Intake Inlet Gasket | 59 | Cover |
| 28 | Intake Valve | 60 | Screw M8X42 |
| 29 | Car. Gasket | 61 | Sleeve |
| 30 | Carburetor | 62 | Felling Dog |
| 31 | Screw ST5X16 | 63 | Screw M5X12 |
| 32 | Intake Holder | 64 | Casting insert |

